

VLP15 Range

Housed IR Camera c/w IR LED



- CCD
- Resolution Colour
- Sensitivity Colour
- Sensitivity Mono
- Infra Red IR LEDs
- IR Range
- Lens Size
- Voltage
- Power Consumption
- Dimensions
- Weight

VLP1514

- 1/3"
- 380 Lines
- 0.1 Lux
- 0.0 Lux IR LED ON
- 12
- 15m
- 4.3mm OR 6mm
- 12V DC
- 300mA / 4.2W (Max)
- 50(Ø) x 135mm (H)
- Approx. 293g

VLP1524

- 1/3"
- 480 Lines
- 0.3 Lux
- 0.0 Lux IR LED ON
- 12
- 15m
- 4.3mm OR 6mm
- 12V DC
- 300mA / 4.2W (Max)
- 50(Ø) x 135mm (H)
- Approx. 293g

The VLP15 collection from Concept Pro is a versatile range of day/night weatherproof cameras that are suitable for a variety of internal and external applications.

Compact and stylish in design, the VLP15 range produce clear, sharp images 24hrs a day. With an in-built array of IR LEDs, the cameras within this range are able to operate in light levels as low as 0.1lux (day) and 0.00lux (IR LED on).

Other Features

- Auto White Balance
- Auto Gain Control
- IP65
- Internal / External
- Weatherproof

Model	VLP1514/6	VLP1514/4	VLP1524/6	VLP1524/4
Scanning System	625 Lines 2:1 Interlace			
Image Sensor	1/3"			
Total/Effective Pixels	470K/440K			
Lens	6mm	4mm	6mm	4mm
Horizontal Resolution	380TVL	380TVL	480TVL	480TVL
Video S/N Ratio	More than 48dB (AGC off)			
Sensitivity	Day (0.3 Lux), Night (0.00 Lux, IR LED On)			
Electronic Shutter	1/50 ~ 1/10,000 sec.			
Day&Night	Auto			
Auto Gain Control	Auto			
Back Light Compensation	Auto			
IR LEDs	850 nm(30°), 12 EA			
Operating temperature	-10°C to +50°C			
Power	DC 12V (9V ~ 15V)			
Dimensions	50(Ø) x 135(D) mm			

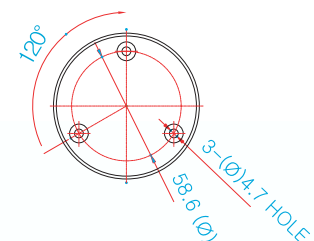
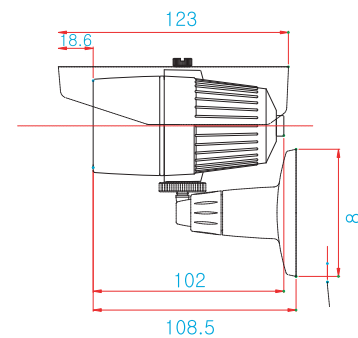

Digital CCTV Limited
 The Old School, Woughton Park, Milton Keynes
 MK6 3AP UK 01908 239239 sales@digitalcctv.com